



SERVICE EXCELLENCE AWARDS WINNER 2001

CYBERCLEAN®

InLine Series

Models

100

200

300

400

500



Standardized Type 2 Protection

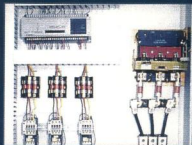

Spray Angle Flexibility



STANDARD FEATURES

- 24" Belt Width
- PLC Controlled
- Stainless Steel Conveyor, Rails and Shaft
- 10 Horse Power Pumps with Overload Protection
- Stainless Steel, High Pressure Plumbing
- Over-temperature Safety Switch
- Redundant Low Liquid Level Safety Switches
- Automatic Fill and Maintain Valve
- Front and Rear Mounted Stainless Steel Pressure Gauges
- SS Valves to Adjust Pressure of Upper & Lower Spray Wands
- Under Belt Tank Screens, Tank Filters and Pump Screens
- Polypropylene Construction
- Adjustable Speed Conveyor with Safety Clutch
- Emergency Stop Safety Switches Mounted at Both Ends of System
- ESD Grounding Blocks Located at Both Ends of Machine

Stainless Steel Plumbing



Effective Drying Technology

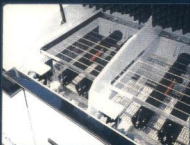

www.emcgti.com

FLOW DIAGRAMS

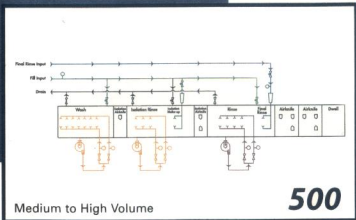
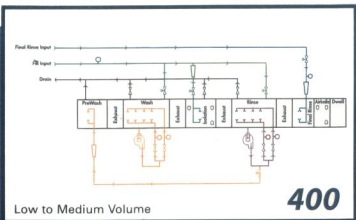
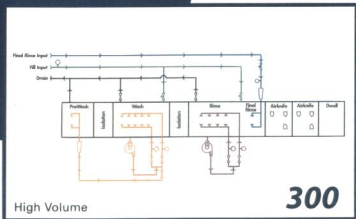
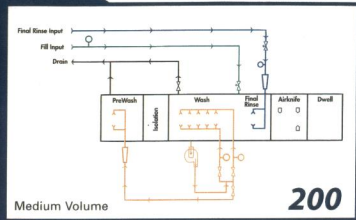
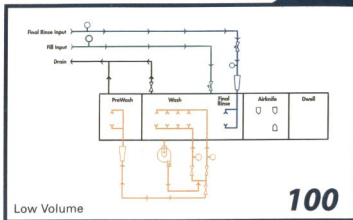

For Water
Soluble
Fluxes

For
Fluxes
Needing
Chemistry
For Their
Removal



EMC
GLOBAL TECHNOLOGIES, INC.

EMC Global Technologies, Inc.

Corporate Headquarters
4059 Skyron Drive
Doylestown, PA 18902
USA

Ph: 215-340-0650
Fax: 215-340-1737

www.emcgti.com